

TILLAMOOK COUNTY SURVEYORS OFFICE
COURTHOUSE, TILLAMOOK, OREGON 97141

1/4 CORNER COMMON SECTIONS 21 & 22 T.2 S.; R.9 W.; W. M.

1/4
|
S21 + S22
|
1961
RS 401

I FOUND A 1 1/2" IRON PIPE WITH A 3" OREGON STATE BOARD OF FORESTRY BRONZE CAP FLUSH IN 10" TILE FILLED WITH CONCRETE, SEE TILLAMOOK COUNTY SURVEYORS REWITNESS CARD #405. I REFERENCED THIS MONUMENT AND RESET THE FOUND PIPE FLUSH IN CONCRETE, AFTER THE FIELD IN WHICH THE MONUMENT WAS LOCATED WAS WORKED UP AND LOWERED ± 2'.

HISTORY OF FOUND MONUMENT

I FOUND THIS MONUMENT TO BE AS DESCRIBED ON TILLAMOOK COUNTY SURVEYORS REWITNESS CARD #405 AND THE REFERENCES FOUND AND/OR SET AT THAT TIME TO NOW BE AS FOLLOWS:

(MAP A-965) 96" MAPLE N.18 1/2° W. 192.6'; REPORTED ON REWITNESS #405 AS FOUND GOOD; NOW FOUND AT POSITION ON NORTHERLY SIDE OF FAWCETT CREEK.

(MAP A-965) 48" MAPLE S.81 1/2° E. 298.4'; REPORTED ON REWITNESS #405 AS FOUND GOOD; NOW GONE, POSITION FALLS IN ERODED AREA IN FAWCETT CREEK.

(REWITNESS CARD #405) PP#F199-L11 N.80°W. 83.25'; FOUND GOOD, AT POSITION. MEASUREMENTS WERE TAKEN TO A FINISH NAIL IN THE SIDE CENTER OF THE POLE. NEW NUMBER ON THE POLE IS 218400.

(REWITNESS CARD #405) PP#F199-L11-SP1 S.6°W. 86.40'; NOW GONE, POLE HAS BEEN REPLACED BY A NEW POLE.

(REWITNESS CARD #405) FOUND 4" X 4" X 48" POST ROTTED OFF AND LYING BESIDE CORNER MONUMENT; NOW GONE.

(REWITNESS CARD #405) SET 96" HAT SECTION POST WEST 1.5'; NOW GONE.

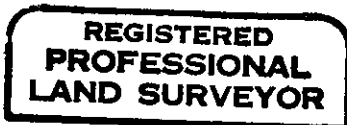

PAGE 1 OF 2

Allan E. Duncan, C.S.

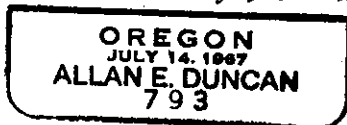

RENEWAL
12-31-03



BOOK 7 347

SURVEYS AND REWITNESSES OF RECORD

A-965	OCTOBER, 1961	RICHARD A. MORRIS	LS 401
A-1003	APRIL, 1962	JOHN L. CARLICH	LS 287
A-1146	MARCH, 1964	JOHN L. CARLICH	LS 287
A-2524	JANUARY, 1974	JOHN L. CARLICH	LS 287
A-4892	MAY, 1983	C. WAYNE COOK	LS 1098
A-4893	MAY, 1983	C. WAYNE COOK	LS 1098
A-5849	JUNE 1989	ALLAN E. DUNCAN	LS 793
B-599	JANUARY 1971	TILLAMOOK COUNTY SURVEYOR	
B-862	SEPTEMBER 1979	FREDERICK GAYLORD	LS 929
B-1227	AUGUST 25, 1986	ALLAN E. DUNCAN	LS 793
B-1675	SEPTEMBER 23, 1990	ALLAN E. DUNCAN	LS 793
B-2018	AUGUST 20, 1996	ALLAN E. DUNCAN	LS 793
REWITNESS CARD 405	AUGUST 24, 1974	JOHN L. CARLICH	LS 287

A-893 SHOWS THIS CORNER AT A DIFFERENT POSITION.
 B-311 SHOWS THIS CORNER AT A DIFFERENT POSITION.

NEW ACCESSORIES

POWER POLE NUMBER 218401 S. 6° W. 86.08'. MEASUREMENTS WERE TAKEN TO A BRASS WASHER AND NAIL IN A SCRIBED TRIANGLE ON THE WEST SIDE CENTER OF THE POLE.

POWER POLE NUMBER 221401 S. 72° E. 192.77'. MEASUREMENTS WERE TAKEN TO A BRASS PP&L NAIL AND WASHER IN A SCRIBED TRIANGLE ON THE NORTH SIDE CENTER OF THE POLE.

LOCATION OF MONUMENT

THIS CORNER IS LOCATED ± 60 FEET NORTH OF FAWCETT CREEK COUNTY ROAD AND ± 160 FEET SOUTH OF FAWCETT CREEK.

IN THE PRESENCE OF AL DVORAK AND DAN MCNUTT

NOVEMBER 28, 2001

TITLE

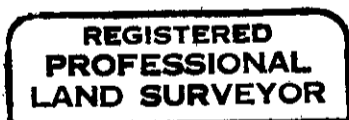

PAGE 2 OF 2

Allan E. Duncan, C.S.

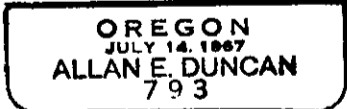

RENEWAL
12-31-03

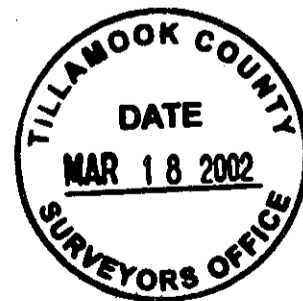

BOOK 7 347